

PLAN
SCALE 1:500

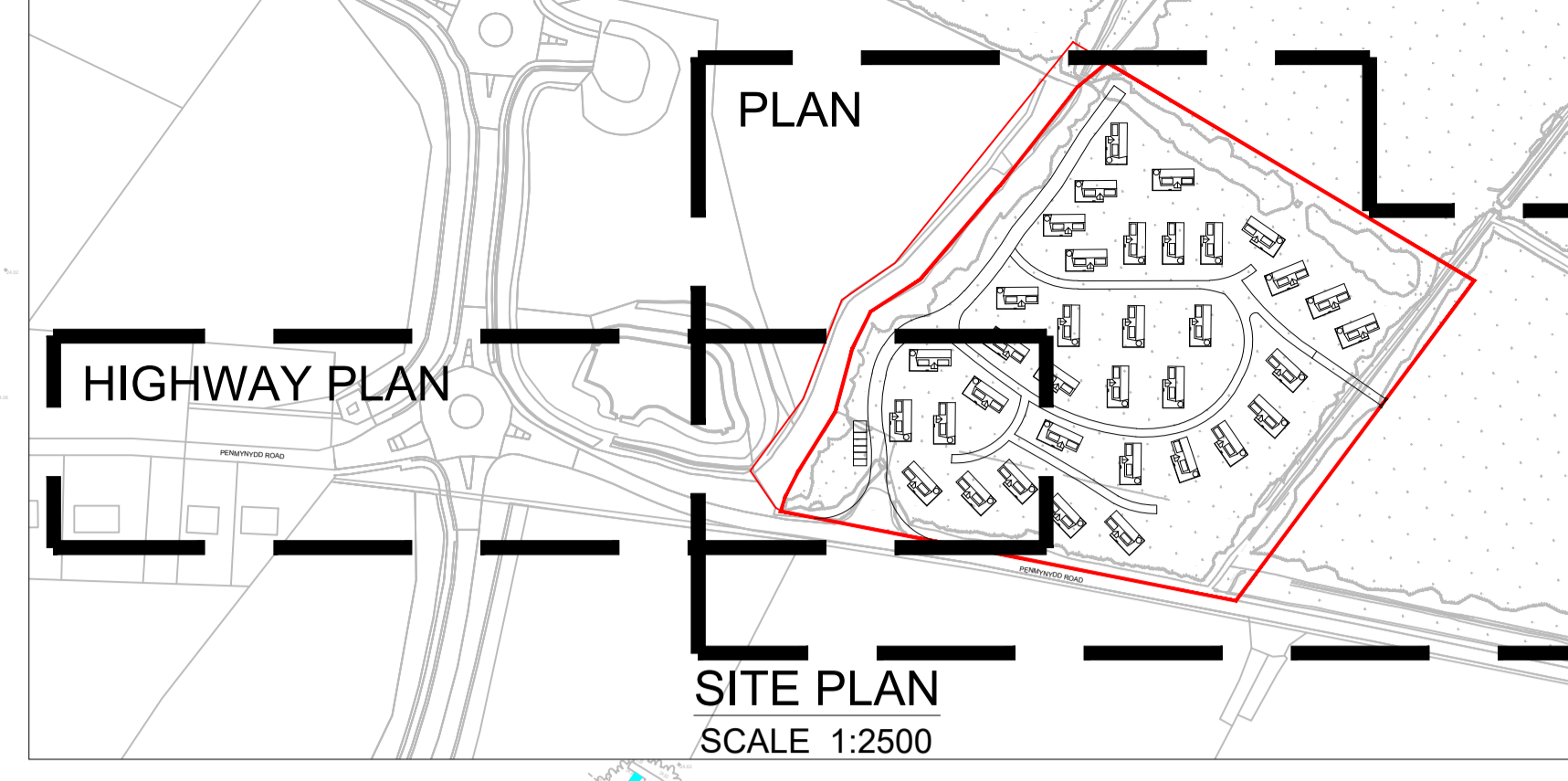

HIGHWAY PLAN

SITE PLAN
SCALE 1:2500

EXISTING GREENFIELD RUNOFF RATES

1:1 YEAR = 2.4 l/s/ha
 QBAR = 2.8 l/s/ha
 1:30 YEAR = 4.9 l/s/ha
 1:100 YEAR = 6.0 l/s/ha

DEVELOPMENT AREAS

TOTAL SITE AREA = 3.01 ha (APPROX.)
 PROPOSED IMPERMEABLE AREA = 0.70 ha (APPROX)

PROPOSED DISCHARGE RATES

PROPOSED SURFACE WATER DISCHARGE RATE = 2.8 x 0.70 = 2.0 l/s (TOO LOW)
 THEREFORE, PROPOSED SURFACE WATER DISCHARGE RATE = 5.0 l/s

EXISTING WATERCOURSE HEADWALL CHAMBER
 TOP OF CONCRETE SLAB 22.560 (APPROX)
 DEPTH TO WATER 0.800
 WATER LEVEL 21.760 (APPROX)
 WATER LEVEL IN PIPE APPROX HALF SUBMERGED
 IL 21.635 (2500 APPROX)
 (BASED ON SITE SURVEY UNDERTAKEN BY TOM AUSTEN
 OF ANGLESEY LODGE AND CARAVAN PARK LTD. 24/06/21)

ATTENUATION BASIN
 TOP LEVEL 22.650
 BASE LEVEL 21.745
 TOP AREA 698 m²
 BASE AREA 438 m²
 SIDE SLOPES 1:3
 AVAILABLE VOLUME 509.5 m³
 1:1 AEP WATER LEVEL 21.889 m AOD
 1:30 AEP WATER LEVEL 22.091 m AOD
 1:100 +40%CC AEP WATER LEVEL 22.433 m AOD

SMH 1.6
 WITH VORTEX FLOW CONTROL
 DEVICE TO LIMIT FORWARD FLOW
 TO 5 l/s AT 1 m HEAD
 CL 22.650
 IL 21.730 (1500)
 BL 21.430 (300mm SUMP)

SMH 1.7
 PROPOSED MANHOLE TO BE
 CONSTRUCTED ON LINE OF
 EXISTING CULVERTED
 WATERCOURSE
 CL 22.650
 IL 21.710 (ASSUMED BASED ON
 GRADIENT OF 1:167)

NOTES

- THIS DRAWING IS TO BE READ IN CONJUNCTION WITH ALL RELEVANT WEETWOOD DRAWINGS
- PIPE GRADIENTS, LENGTHS AND SIZES AND MANHOLE LEVELS SUBJECT TO DETAILED DESIGN FOLLOWING PLANNING APPROVAL AND A FIXED SITE LAYOUT INCLUDING PROPOSED GROUND LEVELS.
- ALL LEVELS ARE IN METERS (AOD)
- ALL PIPE DIAMETERS ARE IN MILLIMETERS

DRAINAGE NOTES

EXISTING WATERCOURSE LEVELS ARE BASED ON INFORMATION PROVIDED WITHIN TOPOGRAPHIC SURVEY UNDERTAKEN BY NRG ENGINEERING SERVICES LTD 31/07/18 AND FURTHER SITE SURVEY UNDERTAKEN BY TOM AUSTEN OF ANGLESEY LODGE AND CARAVAN PARK LTD. 24/06/21

THE LOCATION LINE & LEVEL OF THE EXISTING CULVERTED WATERCOURSE INDICATED ON THE DRAWING IS APPROXIMATE AND FOR GUIDANCE PURPOSES ONLY.

THE LOCATION, LINE & LEVEL OF EXISTING COMBINED DRAINAGE INDICATED ON THE DRAWING IS APPROXIMATE AND FOR GUIDANCE PURPOSES ONLY. IT IS THE CONTRACTORS RESPONSIBILITY TO DETERMINE THEIR EXACT LINE & LEVEL, BY WAY OF HAND EXCAVATED TRIAL PITS, PRIOR TO THE COMMENCEMENT OF ANY EXCAVATION WORKS ON SITE. THE CONTRACTOR SHALL TAKE ALL NECESSARY PRECAUTIONS TO MAINTAIN THE STRUCTURAL INTEGRITY OF ALL ABOVE AND BELOW GROUND SERVICE MAINS / DRAINAGE INSTALLATIONS.

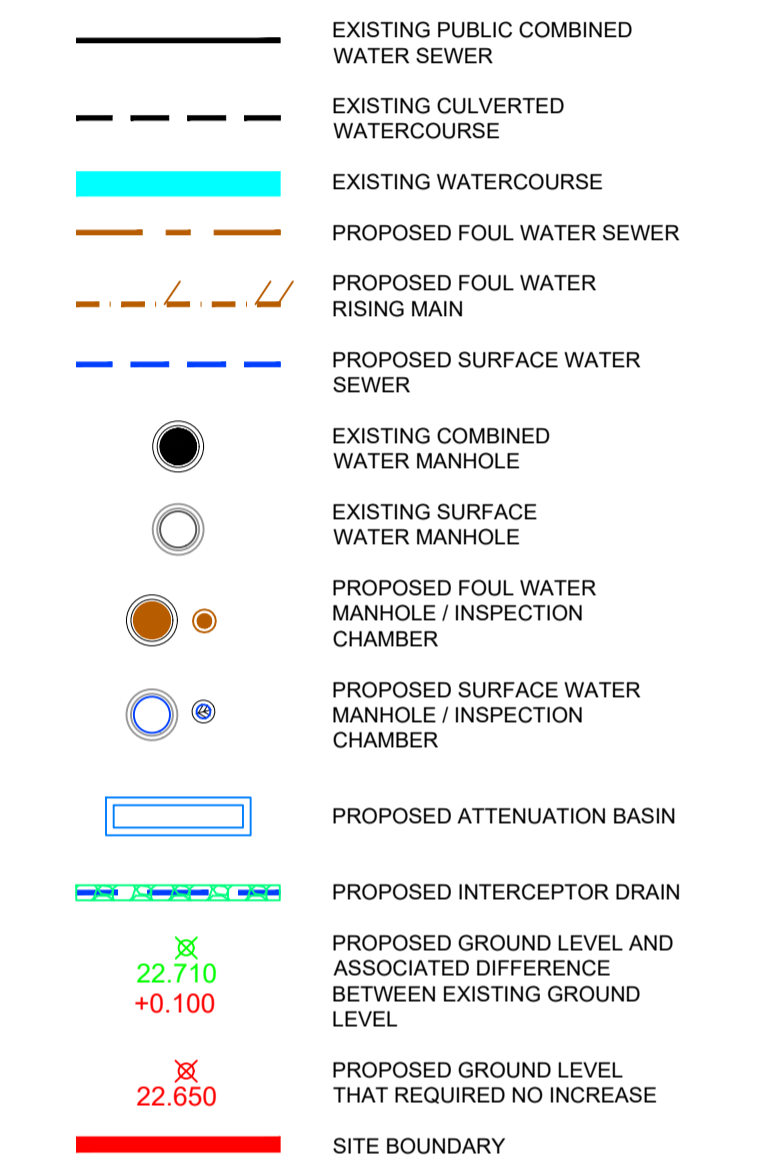

Rev	Date	Description	Drawn	Check
P5	23/12/21	Site layout amended	JR	TB
P4	06/12/21	Site layout amended	JR	TB
P3	03/12/21	Site layout amended	JR	TB
P2	23/11/21	Foul drainage layout added	JR	TB
P1	14/07/21	Issued for information	JR	TB

Weetwood
 Development • Planning • Environment

Park House, Ffordd
 Byrnwr Gwair, Mold
 CH7 1FQ
 Tel 01352 700045
 info@weetwood.net
 www.weetwood.net

Client
ANGLESEY LODGE AND CARAVAN PARK LTD.

Drawing Status
PRELIMINARY

Date
 JULY 2021

Scale (A1)
 1:500

Drawn
 JR

Checked
 TB

Project No
4683

Title
PROPOSED FOUL AND SURFACE WATER DRAINAGE LAYOUT

Project No
4683

Drawing No
C100

Revision
P5

EX DCWW REF: SH47750502
 CL 27.000 (APPROX)
 IL TO BE CONFIRMED

CONTRACTOR TO CONFIRM
 INVERT LEVEL OF EXISTING
 SEWER PRIOR TO
 COMMENCEMENT OF THE
 WORKS AND REPORT
 FINDINGS TO THE ENGINEER

FMH 1.5
 PROPOSED MANHOLE TO BE
 CONSTRUCTED ON LINE OF
 EXISTING 1500 COMBINED
 SEWER
 CL 27.000 (APPROX)
 IL TO BE CONFIRMED

EX DCWW REF: SH47750501
 CL 27.000 (APPROX)
 IL TO BE CONFIRMED



HIGHWAY PLAN
SCALE 1:500

THIS DRAWING MUST BE READ IN CONJUNCTION WITH THE SPECIFICATION AND ALL OTHER RELEVANT DRAWINGS. DO NOT SCALE FROM THIS DRAWING.